



ENDEAVOUR PRIMARY

EDP

毅勤小学

P1 Admin Briefing



Dismissal Arrangement

Lanyard System



Our school uses a lanyard system to help with school dismissal.

1. Allows school staff to identify which gate each student should leave from during dismissal
2. Each student will be issued with a coloured lanyard on the first day of school.
3. Students should wear the lanyard around their necks for at least a month until they are familiar with the dismissal routine.

Coloured Lanyards at the Gates



Gate A

School Hall



BLUE

Gate D

GREEN



RED



Gate C

GATE A – MAIN GATE (BLUE)



GATE C – SIDE GATE (RED)

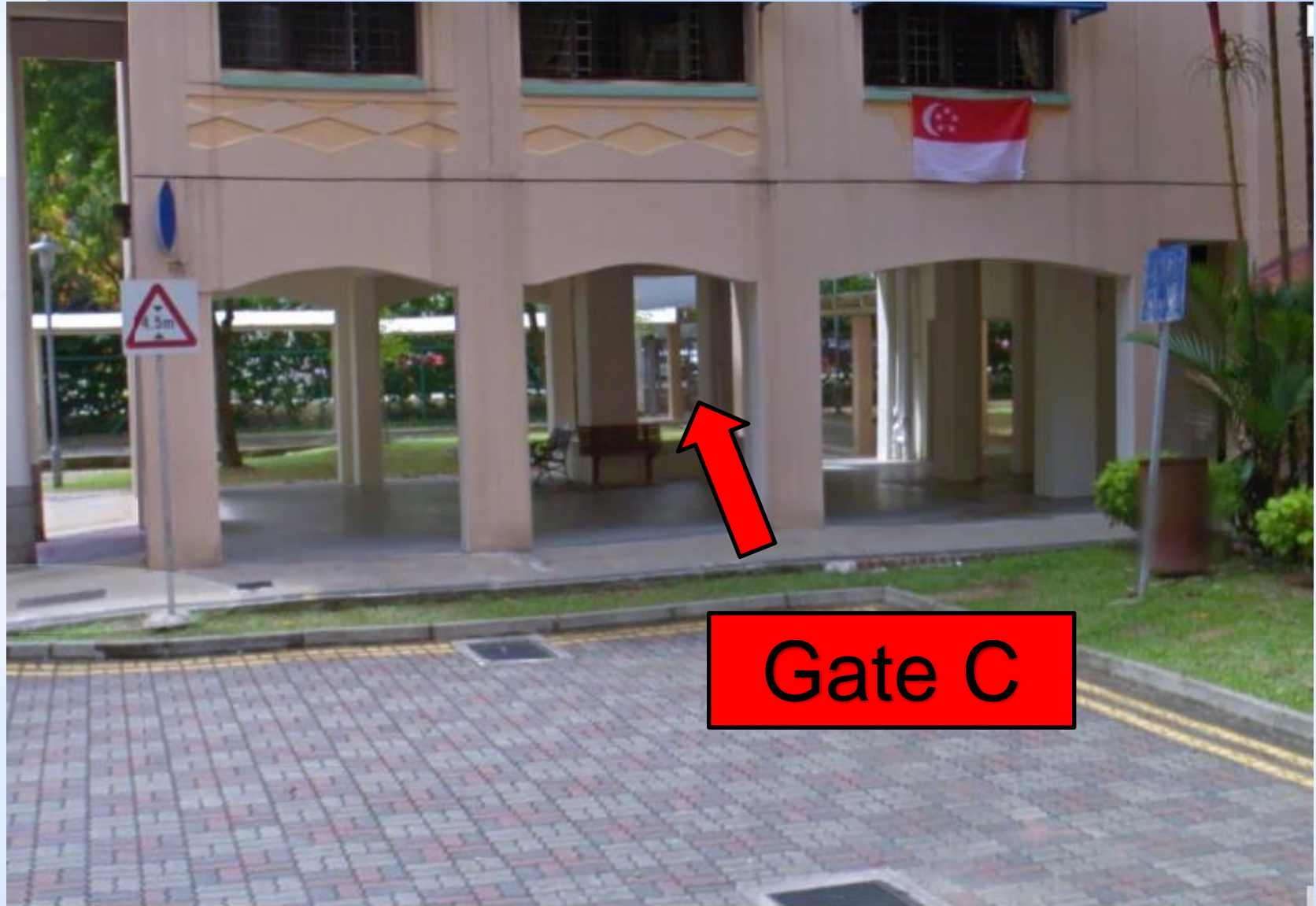

GATE D – BACK GATE (GREEN)



School Map

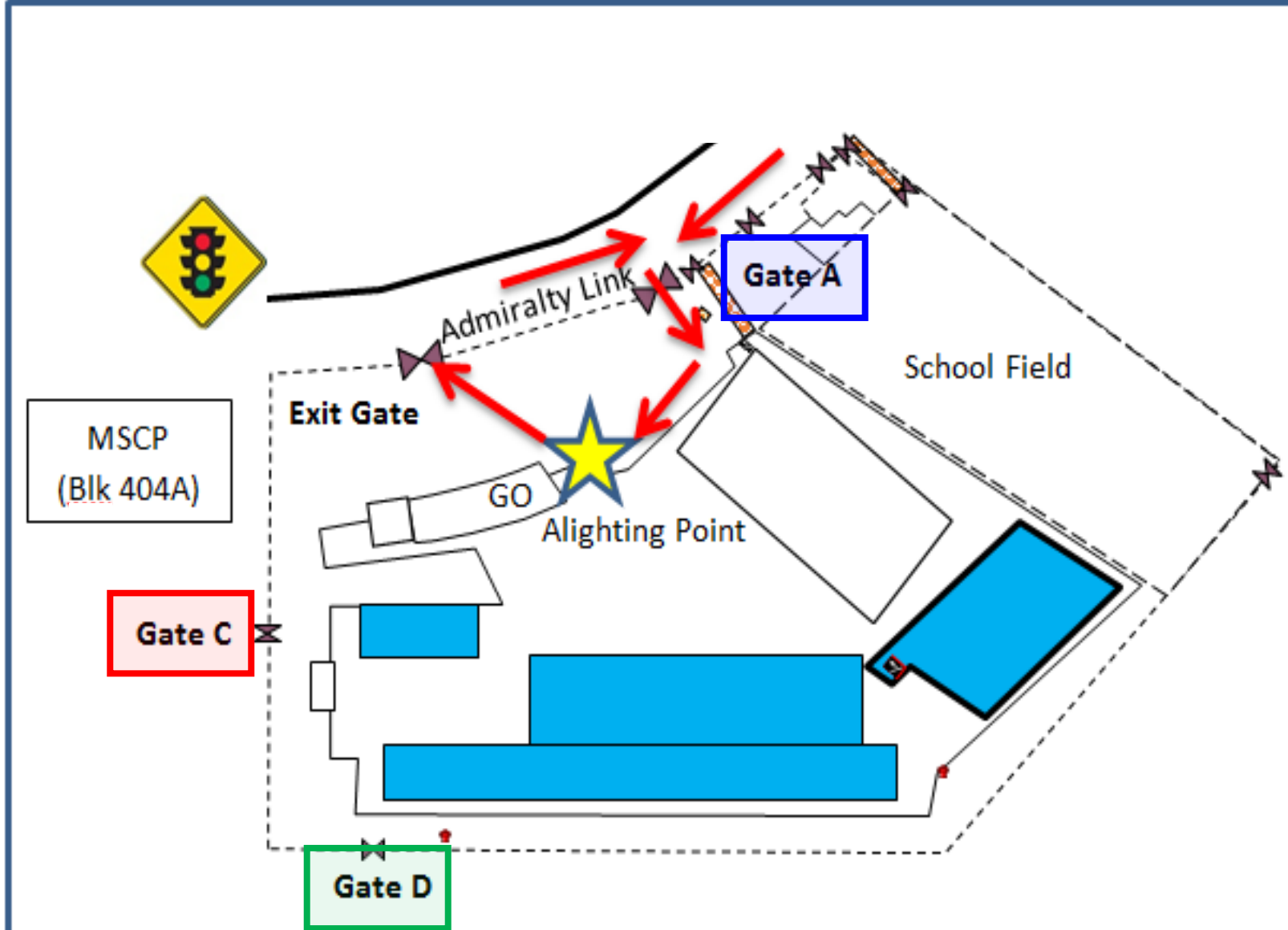

SCHOOL BUS



- A **black lanyard** will be given to your child on the first day of school
- Please remind your child to wear the lanyard for easy identification. The school staff will use the lanyard to guide your child to the respective buses.



Other Dismissal Arrangements



- **Students going to School-based Student Care Centre**

- assemble at school NE corner
- teachers from student care to fetch there



- **Students going to Nascans Student Care Centre by external bus**

- Assemble at school foyer



- **Students going to Mainspring Learning Centre and Reliance Learning Lab,**

- assemble outside library
- teachers from external student care to fetch there



*Teachers will be around to guide the students during the first 2 weeks of school

COLOURED LANYARDS



How does the coloured lanyard system work?

- Scenario 1 ←
- Scenario 2 ←



What to do next?

- Decide which **gate** you will be waiting for your child when school re-opens
- To fill up the online student particular form and indicate dismissal arrangement for your child.

Dismissal Arrangement for First 2 weeks of school



- For the first 2 weeks of school (3 Jan 2023 to 13 Jan 2023), P1 students will be dismissed at the following timings to allow them to get used to the dismissal routine:

Monday	Tuesday	Wednesday	Thursday	Friday
1.10pm	1.10pm	12.40pm	1.10pm	1.10pm

- Parents will not be allowed in the school compound. For parents who are fetching, they should wait at the pre-designated gates by the dismissal timings.
- In the event of heavy downpour, parents who are fetching their children at Gate D may move over to Gate C, which has a sheltered walkway.
- For P1 students who are fetched by their elder siblings during dismissal, they are to wait for their elder siblings at the side door in the school library.

Dismissal Arrangement from 3rd week



- From 3rd week of school onwards (16 Jan 2023), P1 students will be dismissed at the following timings:

Monday	Tuesday	Wednesday	Thursday	Friday
1.25pm	1.25pm	12.55pm	1.25pm	1.25pm



First day of School

Summarized: First day of School (3rd Jan 2023)



- Only P1 students will report on the first day of school on 3rd Jan 2023.
- P1 Orientation will be held on the same day as well.

Primary 1 Orientation Day (3 Jan 2023)

7.20 am	All P1 students are to assemble in the front of the school hall (level 2) Parents will be seated at the back of the school hall.
7.35 am	Flag-raising Ceremony
7.45 am	All P1 students will proceed to the classrooms for their orientation programme.
7.45 am to 9.15 am	Briefing for Parents in the school hall (optional)

Summarized: First day of School (3rd Jan 2023)



Things for your child to bring on 1st day of school:

- Water bottle
- Writing instruments (pencil case)
- Light snacks (snack break at around 12pm)
- Recommended \$2 per day or bring own food for recess

Other Admin Matters

1. Student Particular Form (For School Use)
2. Purchase of Textbooks, Uniforms and School Bus Services (if Applicable)
3. MOE FAS application

Online Student Particular Form

- For our school to keep a record of your child's personal details, including dietary preference, food allergy/ medical condition (if any) and sibling details
- Parents should also indicate their child's dismissal arrangement in the form
- All information will be kept confidential by the school

<https://go.gov.sg/2022spf>

Purchase of Textbooks, Uniforms and School Bus services

While walk-in is allowed, we encourage parents to make your purchases online.

- Bookshop Website:
<https://www.pacificbookstores.com/>
- Uniform vendor Website:
Finest Fashion Centre
<https://finestuniform.com>
- School Bus Services:
Contact Number: 90021501

MOE Financial Assistance Scheme

Areas of assistance	Enhanced Provision from January 2023
Monthly School Bus Subsidy (for primary school students)	65% of monthly school bus fare
Monthly Public Transport Subsidy (for primary to pre-university students)	\$17
School Meal Subsidies	\$2.60 per school meal for 7 meals per school week for primary school
Textbook and school attire	Provided free
Standard Miscellaneous Fees	Full waiver of \$6.50/month

Income Eligibility Criteria:
Gross Household Income (GHI) \leq \$3,000 or
Per Capita Income (PCI) \leq \$750

<https://www.moe.gov.sg/financial-matters/financial-assistance>

Please submit your application to our school by 30 Nov 2022.



Any Questions?

Please e-mail us at
endeavour_ps@moe.edu.sg, or
call us at 64824650



Thank
You!