



P1 Dismissal Arrangement

Lanyard System



Our school uses a lanyard system to help with school dismissal:

1. Allows school staff to identify which gate each student should leave from during dismissal
2. Each student will be issued with a coloured lanyard today.
3. Students should wear the lanyard around their necks for at least a month until they are familiar with the dismissal routine.

How this works?



1. Each coloured lanyard represents a dismissal location.
2. During dismissal, teachers will arrange the students into groups based on the coloured lanyards.
3. Our teachers/ school staff will bring each group to the designated dismissal location.

Coloured Lanyards at the Gates



Gate A



BLUE

Gate D

GREEN



School Hall

RED



Gate C

GATE A – MAIN GATE (BLUE)



GATE C – SIDE GATE (RED)

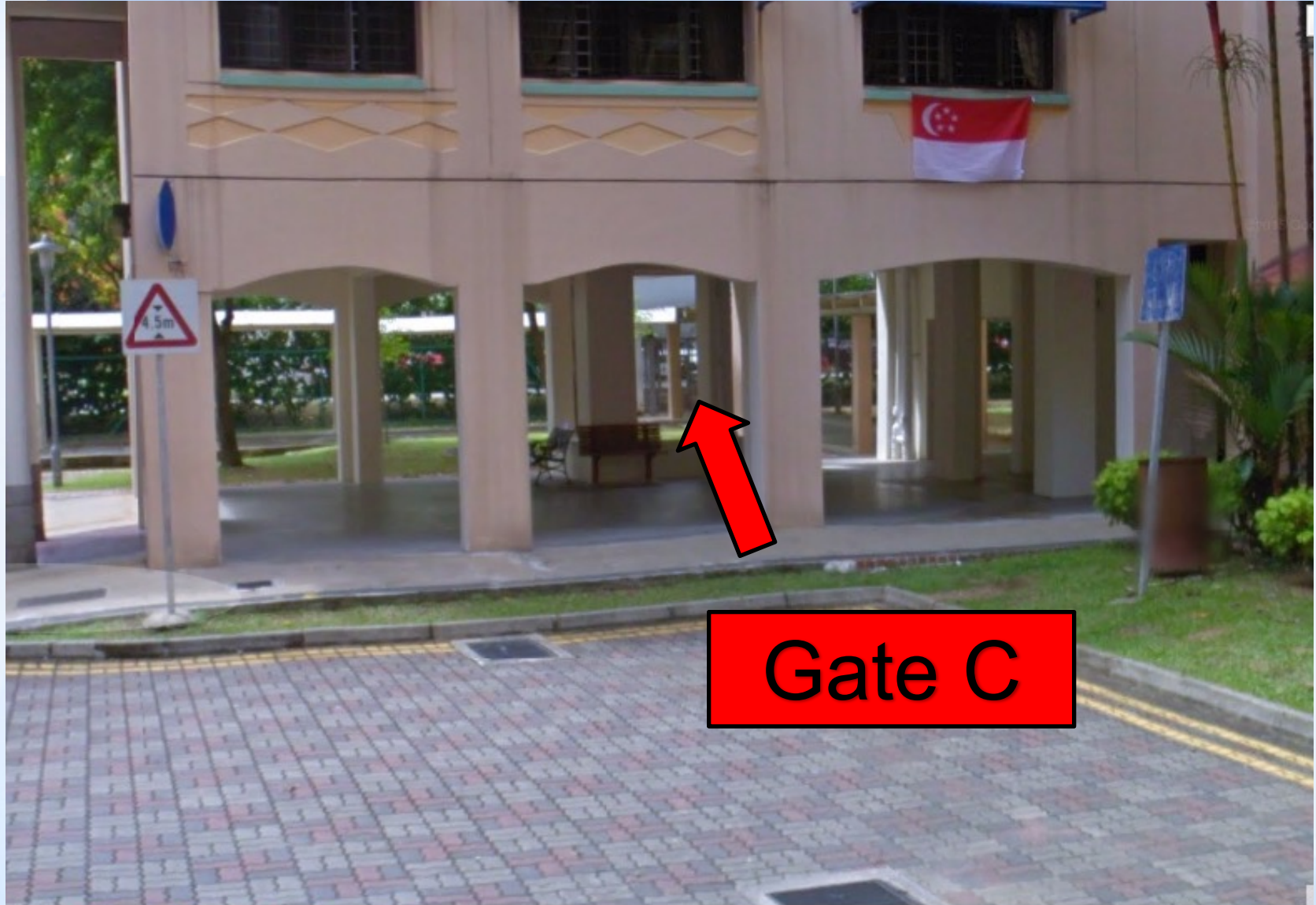

GATE D – BACK GATE (GREEN)



Gate D

School Map

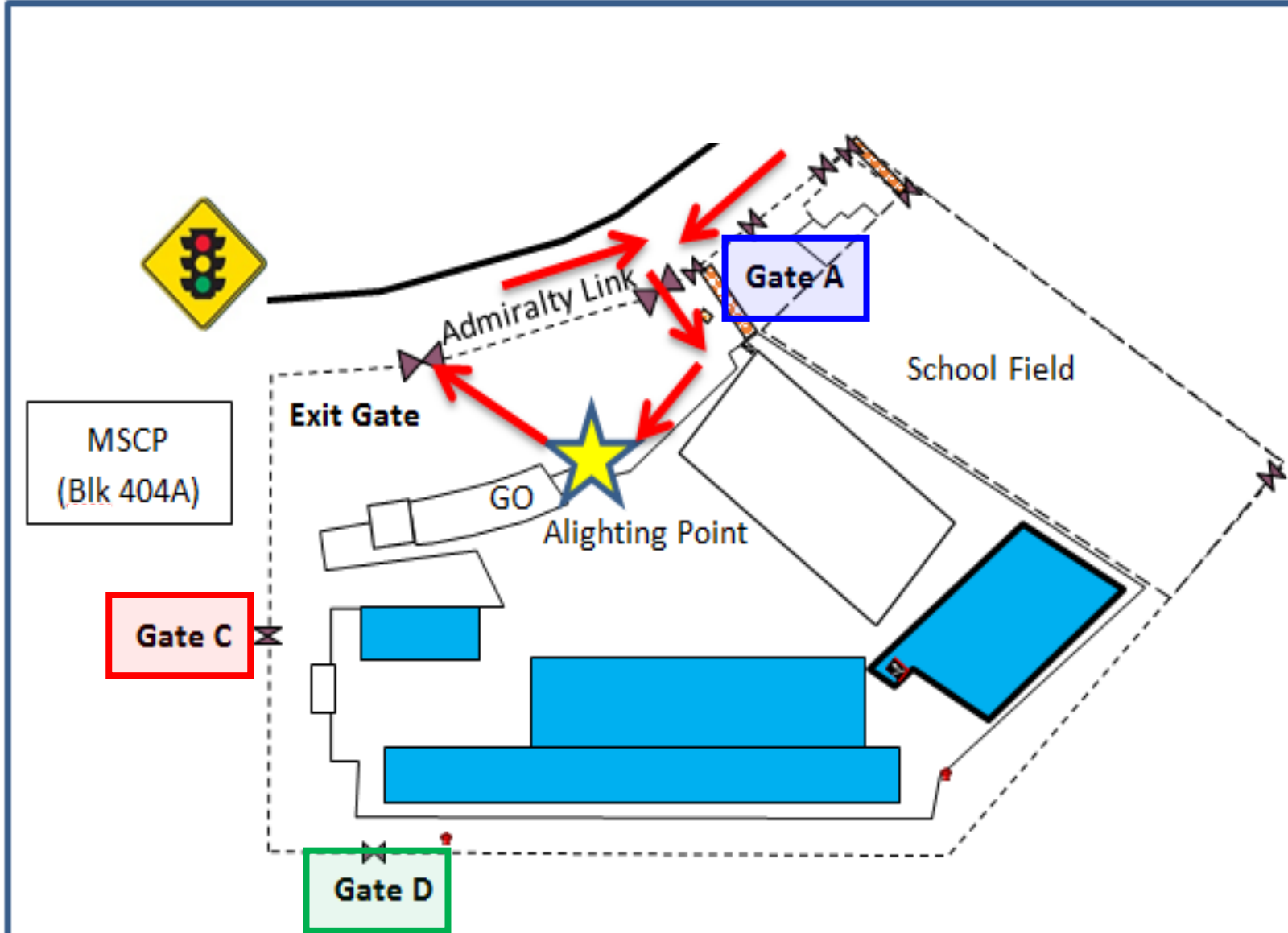

School bus and buses to External Student Care Centres



- A **black lanyard** will be given to those students taking the school bus, or external buses to the student care centre.
- Please remind your child to wear the lanyard for easy identification. Our school staff guide your child to the respective buses based on the colour lanyards.



Other Dismissal Arrangements



- **Students going to School-based Student Care Centre (SCC)**

- assemble at school NE corner
- teachers from School-based SCC to fetch



- **Students going to Mainspring Learning Centre and Reliance Learning Lab,**

- assemble outside library
- teachers from external student care to fetch there



*Teachers will be around to guide the students during the first 2 weeks of school

Dismissal Arrangement for First 2 weeks of school



- For the first 2 weeks of school (3 Jan 2023 to 13 Jan 2023), P1 students will be dismissed at the following timings to allow them to get used to the dismissal routine:

| Monday | Tuesday | Wednesday | Thursday | Friday |
|---------------|----------------|------------------|-----------------|---------------|
| 1.10pm | 1.10pm | 12.40pm | 1.10pm | 1.10pm |

- Parents will not be allowed in the school compound. For parents who are fetching, they should wait at the pre-designated gates by the dismissal timings.
- In the event of heavy downpour, parents who are fetching their children at Gate D may move over to Gate C, which has a sheltered walkway.
- For P1 students who are fetched by their elder siblings during dismissal, they are to wait for their elder siblings at the side door in the school library.

Dismissal Arrangement from 3rd week



- From 3rd week of school onwards (16 Jan 2023), P1 students will be dismissed at the following timings:

| Monday | Tuesday | Wednesday | Thursday | Friday |
|---------------|----------------|------------------|-----------------|---------------|
| 1.25pm | 1.25pm | 12.55pm | 1.25pm | 1.25pm |

Other matters: School uniform and textbook walk-in hours



- **Textbook vendor:** Pacific Bookstore Pte Ltd
 - Walk-in available from Mondays to Fridays, 11.00am to 11.30am, 12.30pm to 2.00pm
- **School uniform vendor:** Finest Fashion Centre
 - Contact number:** 90295135
 - For the first week of school, walk-in available from Tuesday to Friday, 11.00am to 2.00pm
 - Walk-in available every Thursday after 6 Jan 2023



Thank
You!